



TBG 150 P



TBG 150 PN

TBG 150 P

TBG 150 PN

two-stage

pneumatic two-stage
progressive

Gas burner compliant with European standard EN676. Operation:

Continuous modulation operation by installing P.I.D. controller in the control panel (to be ordered separately with modulation probe).

Modulation ratio:

Low NOx and CO emissions gas burner according to European standard EN676:

Adjusting the combustion head.

Maintenance facilitated by the possibility of removing the mixing unit without having to remove the burner from the boiler.

High ventilation efficiency, low electrical input, low noise.

Sliding boiler coupling flange to adapt the blast-pipe to the various types of boilers.

Easy maintenance thanks to the two-sides hinge which allows the removal of the combustion head without having to remove the burner from the boiler.

Combustion air intake with butterfly valve. Air flow adjustment:

Fully closing air damper on shutdown to avoid loss of heat through the chimney.

Combustion air intake designed to achieve optimum linearity of the air gate opening.

Device made of sound-absorbing material to reduce fan noise.

CE version gas train is complete with operation and safety valve with pneumatic drive, valve tightness control, minimum pressure switch, pressure regulator and gas filter.

CE version gas train is complete with butterfly valve, operation and safety valve with electromagnetic drive, valve tightness control, minimum pressure switch, pressure regulator and gas filter.

Fail proof connectors for burner/gas train connection.

Gas train outlet:

Flame detection by ionisation electrode with connector for microamperometer.

Control panel with display diagram for working mode with indication lights.

Electric protection rating:

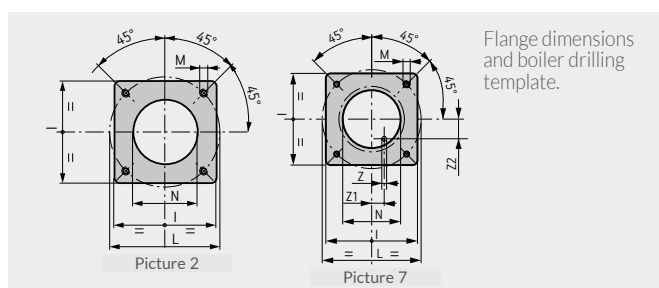
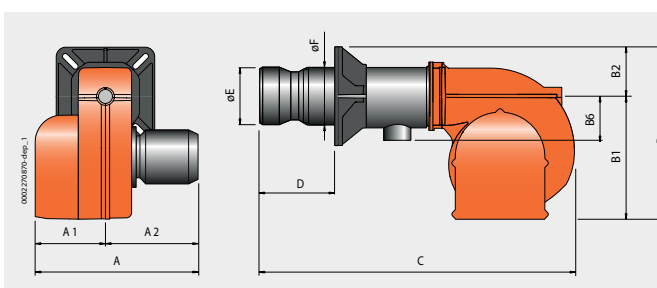

Model	A mm	A1 mm	A2 mm	B mm	B1 mm	B2 mm	B6 mm	C mm	D mm	E mm	F mm	I mm	L mm	M mm	N mm	Z mm	Z1 mm	Z2 mm	Pic.
TBG 150 P	690	320	370	550	380	170	200	1280	200 ÷ 450	240	219	320	280 ÷ 370	M12	250	-	-	-	2
TBG 150 PN	645	275	370	540	380	160	160	1280	200 ÷ 450	240	219	320	280 ÷ 370	M12	250	12	112,5	54	7

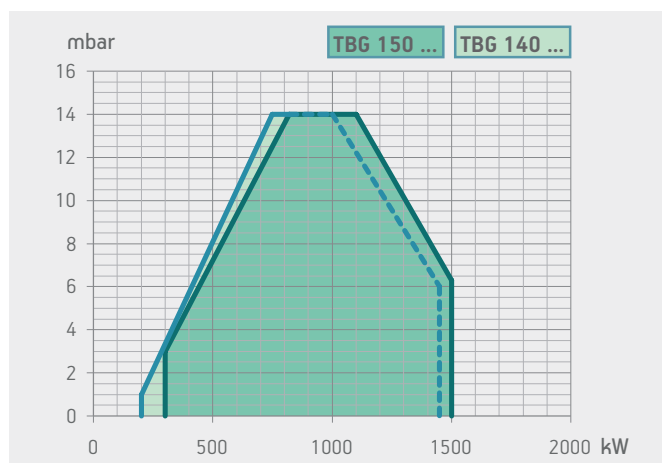

Model	Size of packaging			Weight kg
	L	P mm	H	
TBG 150 P	1070	800	700	91
TBG 150 PN	1070	800	700	91

	Emissions class	Thermal output kW	Model	Part no.	Electrical supply kW	Motor	Note
Frequency 50 Hz							
	class 2	300 ÷ 1500	TBG 150 P	17620030	3N AC 50Hz 400V	2,2	3) 4)
	class 2	300 ÷ 1500	TBG 150 PN	17630010	3N AC 50Hz 400V	2,2	3) 4)
Frequency 60 Hz							
	class 2	300 ÷ 1500	TBG 150 P	17625430	3N AC 60Hz 380V	2,6	3) 4)
	class 2	300 ÷ 1500	TBG 150 PN	17635410	3N AC 60Hz 380V	2,6	3) 4)

The working field of the burner, as expressed in the "Thermal output kW" column, depends on the characteristics of the gas train it works with (see burner/train match diagram).

MODULATING MODE

DESCRIPTION	PART NO.
TBG 150 PN: modulation kit	98000057
TBG 150 PN: modulating probe kit (see page 288)	

ACCESSORIES AVAILABLE ON REQUEST

DESCRIZIONE	PART NO.
Soundproof burner cover (see page 293)	97980053

GAS BURNERS ACCESSORIES

Boiler coupling kit, plug for wiring.

NOTES

3 Sound proof lid on burner air intake.

4 Equipped with air closure device.

Net calorific value at reference conditions of 0°C, 1013mbar:

Natural gas: $H_i = 35,80 \text{ MJ/m}^3 = 8550 \text{ kcal/m}^3$,

LPG: $H_i = 92 \text{ MJ/m}^3 = 22000 \text{ kcal/m}^3$.

For different type of gas and pressure values, please get in contact with our commercial department.